

B R O O M F I E L D

450

# Medium-Duty Coil Winding Machine

## SPECIFICATIONS

The **Broomfield 450** coil winding machine is a cost effective solution that provides for winding up to a 80"(2032mm) diameter coil.

### Features & Benefits:

- "LOW COST" Solution
- Steel construction for superior strength.
- Electrically actuated brake for positive stopping.
- Electronic controls for stopping at the desired turns count.



(1) SHOWN WITH OPTIONAL MULTI-PROGRAM TOUCH SCREEN  
(2) OPTIONAL TAILSTOCK AVAILABLE

B R O O M F I E L D

450

# Medium-Duty Coil Winding Machine

**Motor Equipment:** 3 HP (2.24Kw) AC Vector motor and drive with foot controlled variable speed.

**Faceplate:** 14" (356mm) diameter.

**Reduction:** Gear reducer.

### Spindle Speeds and Corresponding Torques

0-43 rpm	365 ft.-lbs.*	(495Nm)
0-58 rpm	270 ft.-lbs.*	(366Nm)
0-70 rpm	225 ft.-lbs.**	(305Nm)
0-87 rpm	180 ft.-lbs.*	(244Nm)
0-116 rpm	135 ft.-lbs.*	(183Nm)
0-175 rpm	90 ft.-lbs.*	(122Nm)
0-233 rpm	67 ft.-lbs.*	(91Nm)

\* assumes 100% efficient gear train.

\*\* Only (1) may be chosen.

**Power Requirement:** Electrical: 220 V, three phase, 30 amps. Other voltages available.

**Spindle Rotation:** Either direction can be selected by a switch on the control panel.

**Spindle Center Height:** 41" (1041mm) from the floor.

**Brake:** Electromagnetic spring set disc brake operated by removing foot from variable speed control, by total turns counter or by emergency stop button.

**Tailstock:** Mounted on precision ways to allow positioning anywhere along winding axis. 4" (102mm) quill travel. 60° live center in No. 4 Morse Taper.

### Maximum Distance Between Centers:

**450B:** 48" (1218mm)

### Maximum Swing Diameter: 450A: 80" (2032mm)

**450B:** 63" (1600mm)

**Machine Control:** Electronic turns counter with digital display, provides programming of a slow down and stop turns count valve.

**Weight: 450A:** 875 lbs. (397Kg)

**450B:** 1,700 Lbs. (772Kg)

### Options:

- Winding forms and toolings.
- Various headstock/tailstock holding fixtures.
- Longer machine length.
- 5 HP (3.73Kw) spindle motor for speedranges above 87 rpm.
- Fiberglass Banding assembly.
- Custom modifications for special applications.
- Touch screen, multi-program controller.

### 450A Model

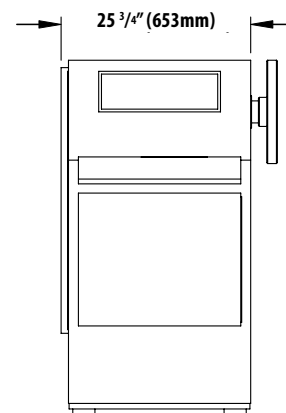
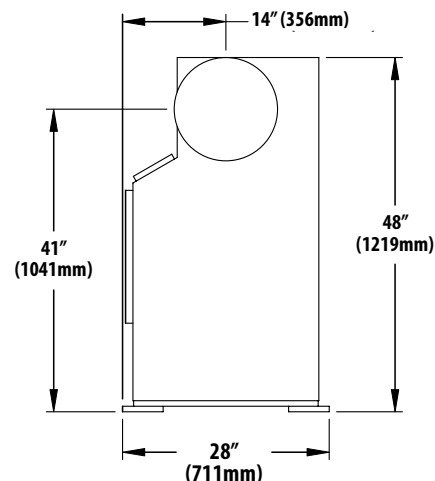

### 450B Model

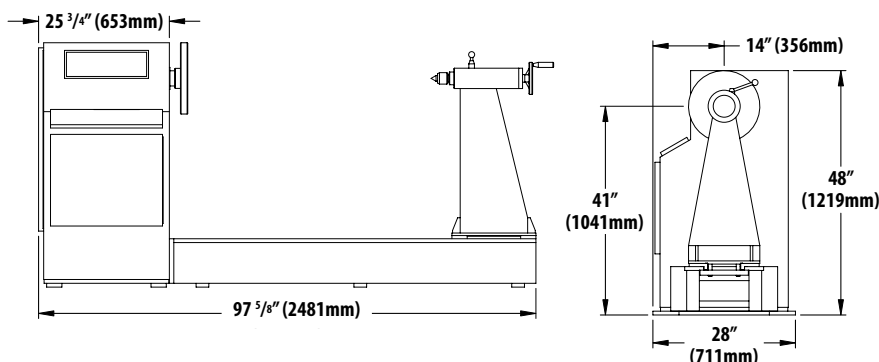

P.O. BOX 157  
113 STILL RIVER ROAD  
BOLTON, MA 01740-0157 USA  
P: 1-978-779-6600  
F: 1-978-779-2954  
E: info@broomfieldusa.com

WWW.BROOMFIELDUSA.COM

**BROOMFIELD**