

B R O O M F I E L D

400

Multi-Speed, Medium to Heavy-Duty Coil Winder

SPECIFICATIONS

The **Broomfield 400** coil winding machine has a large diameter winding capacity and can be purchased without a wire guide traverse mechanism, for hand winding.

Features & Benefits:

- Three models available:
 - 400A:** Winding headstock.
 - 400B:** Winding headstock with tailstock mounted on precision ways.
 - 400C:** Winding headstock, tailstock on precision ways and automatic wire traversing mechanism.
- Eight speed ranges with variable speed within each range. Maximum speed 590 RPM.
- Heavy-duty welded steel construction for superior strength.
- Electrically actuated disc brake for positive stopping.
- Electronic wire guide traverse: Two precision layering styles are provided; Parallel and Spiral.
- Set-up time is minimized by use of electronic controls for setting wire pitch and stopping at the desired turns count (Model 400C). The operator only needs to enter this data and set the winding width stops. Winding speed ranges are easily selected.
- Reverse bend system eliminates need for pounding wire or pressing coils into shape, produces tighter coils and uses less wire.
- Easily adaptable for winding single or multiple coils.



B R O O M F I E L D

400

Multi-Speed, Medium to Heavy-Duty Coil Winder

Motor Equipment: 3 HP (2.23 KW) AC Vector motor and drive with foot controlled variable speed.

Faceplate: 14" (356mm) diameter

Primary Reduction: Belt and pulley.

Secondary Reduction: Four speed gearbox.

Spindle Speeds and Corresponding Torques

Low:

0-28 rpm	560 ft.-lbs.	(759Nm)
0-73 rpm	214 ft.-lbs.	(290Nm)
0-110 rpm	142 ft.-lbs.	(193Nm)
0-295 rpm	52 ft.-lbs.	(70Nm)

High:

0-55 rpm	285 ft.-lbs.	(386Nm)
0-146 rpm	108 ft.-lbs.	(146Nm)
0-220 rpm	70 ft.-lbs.	(95Nm)
0-590 rpm	27 ft.-lbs.	(37Nm)

Power Requirement: Electrical: 220 V, three phase, 30amps. Other voltages available.

Spindle Rotation: Either direction can be selected by a switch on the control panel.

Spindle Center Height: 43" (1092mm) from the floor.

Brake: Electro-magnetic spring set disc brake.

Tailstock: Mounted on precision ways to allow positioning anywhere along winding axis. 4" (102 mm) quill travel. 60° live center in No. 4 Morse Taper.

P.O. BOX 157
113 STILL RIVER ROAD
BOLTON, MA 01740-0157 USA
P: 1-978-779-6600
F: 1-978-779-2954
E: info@broomfieldusa.com

WWW.BROOMFIELDUSA.COM

Maximum Distance Between Centers: 400B & 400C: 42.5" (1080 mm)

Maximum Swing Diameter: 400A: 83" (2108mm)
400B: 63" (1600mm), **400C:** 32" (813mm)

Machine Control: A & B Models: Programmable Electronic Counter. **C Model:** S-50 Winding Controller with 50 programmable stops, 7 program capacity, parallel and spiral layering and end stops to define winding width. (See S-50 page for details)

Weight: 400A: 1200 lbs. (545 kg),
400B: 2200 lbs. (1000 kg), **400C:** 2600 lbs. (1180 kg)

Options:

- Broomfield MP-4 Controller automatically coordinates winding functions and provides for program storage. (See MP-4 page for details)
- Multiwire guide assembly.
- Pulleys for square and rectangular wire.
- Automatic Run.
- Longer or shorter machine length.
- 5 HP (3.7Kw) spindle motor.
- Heavy-duty tailstock and winding area guard.
- Paper insulation dereeler/tensioners.
- Multiple coil winding.
- Custom modifications for special applications.

400A Model

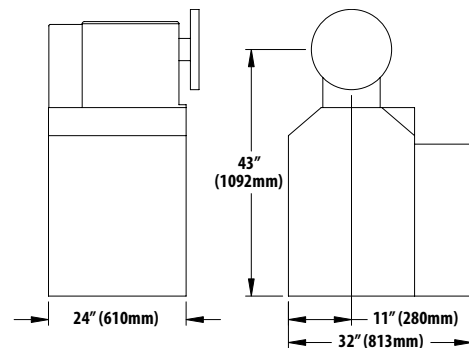

400B Model

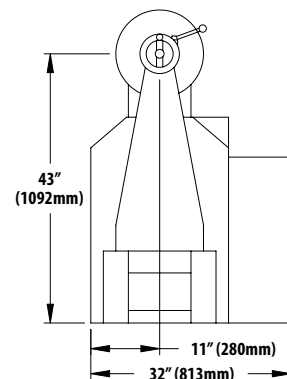
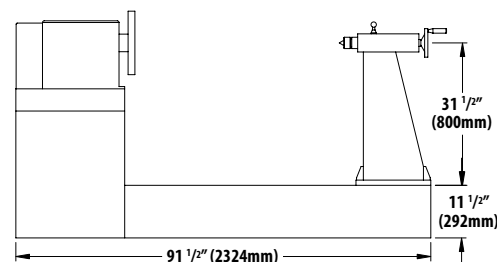

400C Model

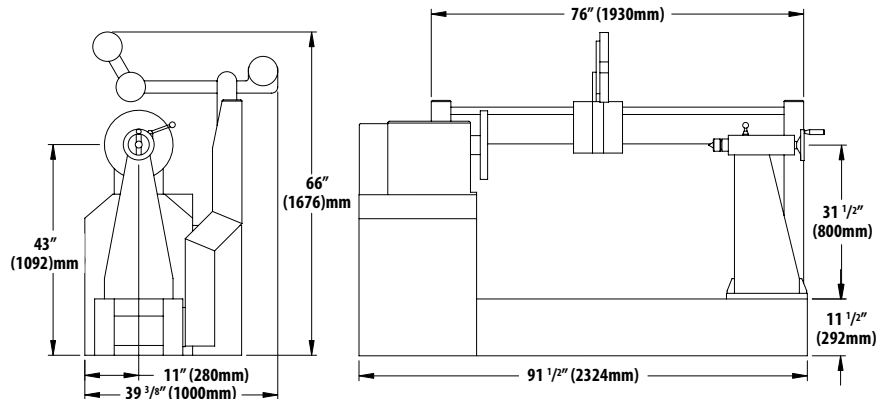

BROOMFIELD