

B R O O M F I E L D

350

Multi-Speed, Medium to Heavy-Duty Coil Winder

SPECIFICATIONS

The **Broomfield 350** will wind heavier round or shaped wire onto coils up to 28" (711mm) diameter. Four speed ranges and very versatile, this is one of our most popular models.

Features & Benefits:

- Four speed ranges with variable speed within each range. Maximum speed 535 RPM.
- Heavy-duty welded steel construction for superior strength.
- Electrically actuated disc brake for positive stopping.
- Electronic wire guide traverse: Two precision layering styles are provided; Parallel and Spiral.
- Set-up time is minimized by use of electronic controls for setting wire pitch and stopping at the desired turns count. The operator only needs to enter this data and to set the winding width stops. Winding speed ranges are easily selected.
- Reverse bend system eliminates need for pounding wire or pressing coils into shape, produces tighter coils and uses less wire.
- Easily adaptable for winding single or multiple coils.



B R O O M F I E L D

350

Multi-Speed, Medium to Heavy-Duty Coil Winder

Motor Equipment: 5HP (3.73Kw) AC Vector motor and drive with foot controlled variable speed.

Faceplate: 14" (356 mm) diameter.

Primary Reduction: Belt and pulley.

Secondary Reduction: Four speed gearbox.

Spindle Speeds and Corresponding Torques

Low:

0-50 rpm	525 ft.-lbs.	(712Nm)
0-133 rpm	197 ft.-lbs.	(267Nm)
0-200 rpm	131 ft.-lbs.	(178Nm)
0-535 rpm	49 ft.-lbs.	(66Nm)

Power Requirement: Electrical: 220 volt, three phase, 40 amps. Other voltages available.

Spindle Rotation: Either direction can be selected by a switch on the control panel.

Spindle Center Height: 43" (1092mm) from the floor.

Brake: Electromagnetic spring set disc brake operated by removing foot from variable speed control, by total turns counter or by emergency stop button.

Tailstock: Mounted on precision ways to allow positioning anywhere along winding axis. 4" (102mm) quill travel. 60° live center in No. 3 Morse Taper.

Maximum Distance Between Centers: 47 1/4" (1200mm).

Maximum Swing Diameter: 30" (762mm)

Machine Control: S-50 winding controller with 50 programmable stops, 7 program capacity, parallel and spiral layering and end stops to define winding width. (See S-50 page for details)

Weight: 3100 lbs. (1400Kg)

Options:

- Broomfield MP-4 controller automatically coordinates winding functions and provides for program storage. (See MP-4 page for details)
- Multi-wire guide assembly.
- Pulleys for square and rectangular wire.
- Automatic Run.
- Higher speed range.
- Winding area guard.
- Paper insulation dereeler/tensioners.
- Multiple coil winding.
- Custom modifications for special applications.

350 Model

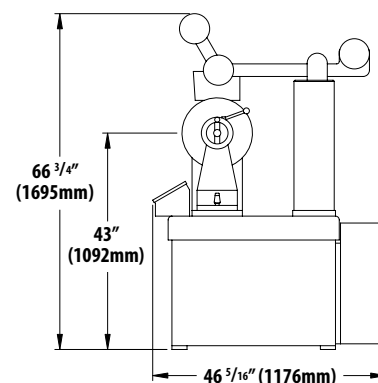
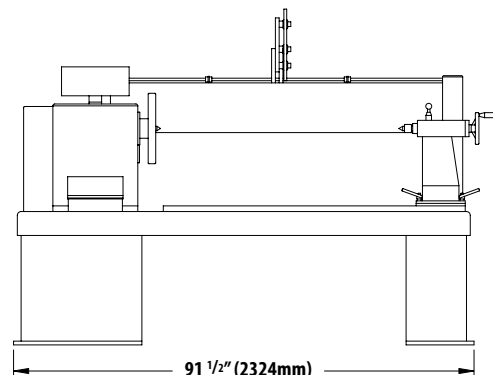

P.O. BOX 157
113 STILL RIVER ROAD
BOLTON, MA 01740-0157 USA
P: 1-978-779-6600
F: 1-978-779-2954
E: info@broomfieldusa.com

WWW.BROOMFIELDUSA.COM

BROOMFIELD